

# duotight Manifold Guide

KL46220 | KL46237 | KL46244 | duotight Manifold | Disassembly & Cleaning



## duotight Manifold Disassembly | Cleaning

The duotight Manifolds with Check Valves & Isolation Valves are designed for easy disassembly and cleaning. This is to allow for easy basic maintenance and also for deep cleaning should contaminants such as beer enter the manifold.

Please note that the integrated check valves may not operate correctly unless clean and free of contaminants.

To disassemble the manifold for cleaning, use a small flathead screwdriver or similar to pry and remove the black clips on each side of the duotight housing. Once all four clips are removed the duotight ball valves can be pulled out of the manifold housing.

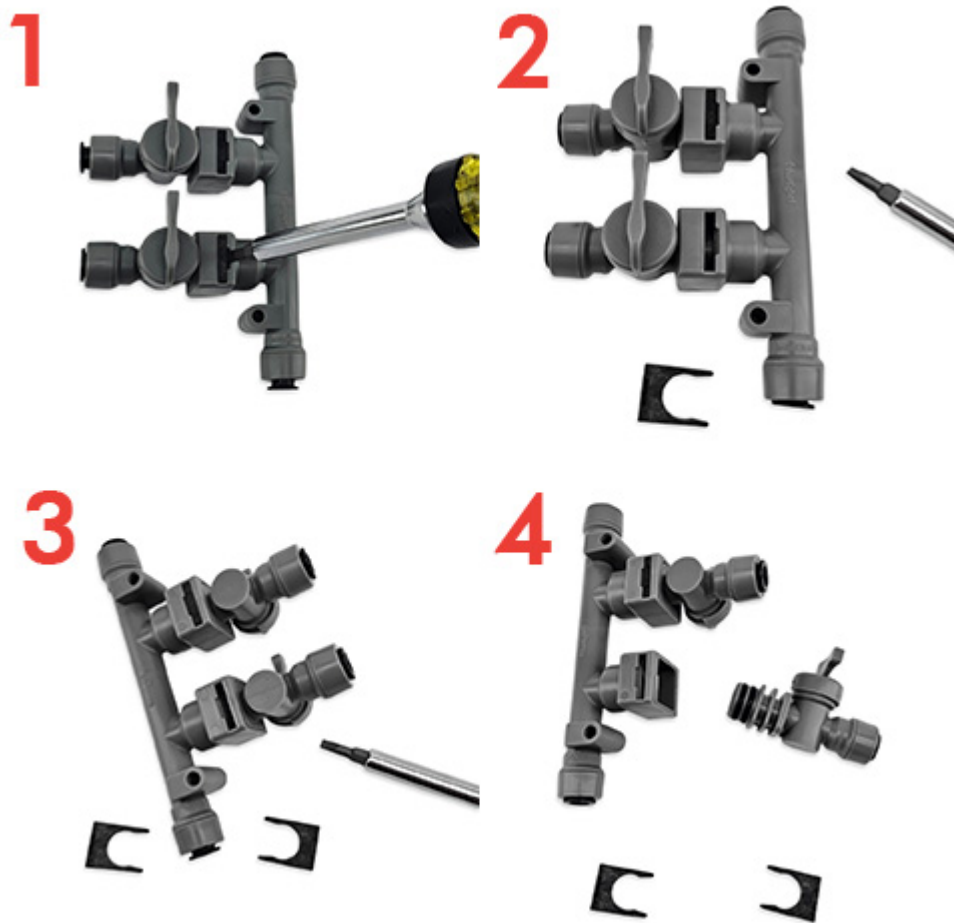

duotight manifold ball valve removal

NOTE: KL46220 2 Way Manifold is used for illustration. The same process applies to KL46237 4 Way Manifold and KL46244 6 Way Manifold as well

Once both duotight ball valves are removed use a pick tool or similar to gently pry out the removable check valve from each duotight fitting.



duotight manifold check valve removal

Once disassembled, soak all parts in a warm [StellarClean PBW](#) solution until clean. Rinse each piece thoroughly in warm water, then reassemble and test.

### duotight Manifold Orientation

The duotight ball valves can be assembled in the manifold housing in different orientations as required.

To do this, follow the disassembly steps above. Once the duotight ball valve fitting is removed, replace it in the housing in the desired orientation and replae the clips, ensuring these are correctly seated.



KL46220 duotight Manifold - Orientation Example